



The Palm Grip B6 has different equipment options for many requirements. It is compatible with our Multi-Axis Controller or mounted on hydraulic drives. The Palm Grip has a highly flexible cable (4 respectively 8 x 0,25 mm², 450 mm long). The mounting piece can be supplied with a tapped hole M10 (standard) or M8.

Technical data

Operating temperature	-40°C to +85°C
Degree of protection	IP54
Contact complement	1,5A 24 V DC13



	B6	Example -2D	K	-X
Basic unit				
B6 Palm Grip				
Digital actuating element				
D Push Button top				
W Rocker switch top T-0-T				
W Rocker switch top R-0-T				
W Rocker switch top R-0-R				
K* Lever switch				
* Included with the delivery of Palm Grip B6!				
Special model				
X Special / customer specified				

B6

Edition:
Lever switch side
Rocker switch installed top

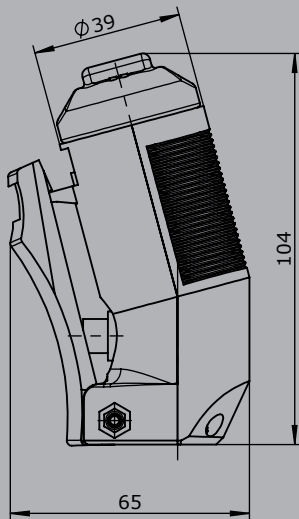

Edition:
Lever switch side
Push button top

