



Type V3LT-02Z+02ZP-...

The multi-axis controller V 3 is a rugged switching device according IEC 947-5-1 EN 60947 DIN VDE 0660-200 for hoisting applications. The modular design enables the switching device to be used universally. The V 3 is resistant to oil, maritime climate, ozone and UV radiation.

**Contact complement 4 A 250 V AC 15 res. 1 A 24 V DC 13**

Mechanical life 6 million (operating cycles)  
Permissible ambient temperature Operation -40° C to +60° C  
Storage -50° C to +80° C

Climate resistance  
Damp heat constant DIN IEC 68 part 2-3  
Damp heat cyclic DIN IEC 68 part 2-30  
Degree of protection front IP 54 IEC 529 DIN 40050  
Technical data see catalog 5/100  
Description data see catalog 5/002

Spindle block with schematic representation of the master controller installation and deflection directions.  
Version shown for left-hand side installation (right-hand side installation is mirror image).

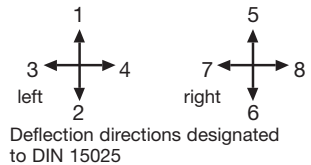

| Pos. | V 31   | V 3                           | Type expansion    | Weight gramm | Type | Price EURO |  |
|------|--|-------------------------------|-------------------|--------------|------|------------|--|
| 1    |  |                               |                   | 940          | V 31 |            |  |
| 2    |  |                               |                   |              |      |            |  |
| 3    |  |                               |                   |              | 1000 | V 3        |  |
| 4    |  |                               |                   |              |      |            |  |
| 5    |  |                               |                   |              |      |            |  |
| 7.1  | Multi-axis controller left   | (dir. 1-2, 3-4)               |                   |              | L    |            |  |
| 7.2  | Multi-axis controller right  | (dir. 5-6, 7-8)               |                   |              | R    |            |  |
| 10   | Gate cross-shaped  | (prohibits diagonal shifting) |                   | 100          | P    |            |  |
| 11   | Gate special-shaped  | (e.g. H-gate)                 |                   | 110          | PX   |            |  |
| 20   | Control-handle with knob solid   |                               |                   |              |      |            |  |
| 21   | Control-handle with latch for mechanical zero interlock by lifting   |                               |                   | 50           | M    |            |  |
| 21.4 | Mechanical zero interlock with command devices see catalog 1/282   |                               |                   |              |      |            |  |
| 22   | Control-handle with dead man's button 1 NO   |                               |                   | 100          | T    |            |  |
| 23   | Control-handle with signal button 1 NO   |                               |                   | 100          | H    |            |  |
| 24   | Control-handle with push button 1 NO   |                               |                   | 110          | D    |            |  |
| 25   | Control-handle with flat push button 1 NO  |                               |                   | 110          | DV   |            |  |
| 26   | Control-handle with palm grip B 1  |                               |                   | 40           | B 1  |            |  |
| 27   | Control-handle with palm grip B 1 with push button top 1 NO  |                               |                   | 60           | B 1T |            |  |
| 28   | Control-handle long or short   |                               |                   |              |      |            |  |
| 28.1 |  | -20 mm                        |                   |              | S5   |            |  |
| 28.2 |  | +20 mm                        |                   |              | S8   |            |  |
| 29   | More knobs, grips and T-grips with and without signal devices see catalog 1/280...   |                               |                   |              |      |            |  |
| 30   | Masterswitch (contact) switching sequenc 4-0-4   |                               | No. of contacts 2 | 290          | 01   |            |  |
| 31   |  |                               | 4                 | 350          | 02   |            |  |
| 32   | Direction 1-2 and 3-4 each 1 masterswitch  |                               | 6                 | 410          | 03   |            |  |
| 33   | Switching program according contact-arrangement MS... see catalog 5/001 or to your contact-arrangement   |                               | 8                 | 470          | 04   |            |  |
| 34   |  |                               | 10                | 530          | 05   |            |  |
| 35   |  |                               | 12                | 590          | 06   |            |  |
| 36   | Switching sequence 5-0-5   |                               |                   |              |      |            |  |
| 38   | Spring return in 0-position  | (for each direction)          |                   | 110          | Z    |            |  |
| 39   | Friction brake adjustable  | (for each direction)          |                   | 50           | R    |            |  |
| 40   | Potentiometer e.t.c. each masterswitch with mounted Wire-wound potentiometer T 130, with centre tap, 1,5 Watt wiper current max. 10 mA resistance 2 x 0,5k $\cong$ P021, 2 x 1k $\cong$ P022, 2 x 2k $\cong$ P023, 2 x 5k $\cong$ P024, 2 x 10k $\cong$ P025 |                               | ...P02 $\square$  | 70           | P    |            |  |
| 41   | Prepared for mounting potentiometer shaft 6 mm adjusting-angle 2 x 150°  |                               | P...              |              | (P)  |            |  |
| 42   | Prepared for mounting potentiometer e.t.c. adjusting-angle variable.   |                               |                   |              | (P)  |            |  |
| 43   | more Potentiometer e.t.c. see catalog 1/240...   |                               |                   |              |      |            |  |
| 50   | Steel sheet housing B 200 masterswitch max. size 04  |                               |                   | 1300         | B    |            |  |
| 51   | Steel sheet housing B 230 masterswitch max. size 06  |                               |                   | 1400         | B    |            |  |
| 52   | More housing see catalog 1/350   |                               |                   |              |      |            |  |
| 60   | Indicating labels not engraved with 2 or 4 arrows  |                               |                   |              |      |            |  |
| 61   | Engraving, each 10 characters  |                               |                   |              |      |            |  |
| 70   | Command and indicating devices see catalog 1/360   |                               |                   |              |      |            |  |



T = dead man's button  
H = signal button  
M = latch for mechanical zero interlock

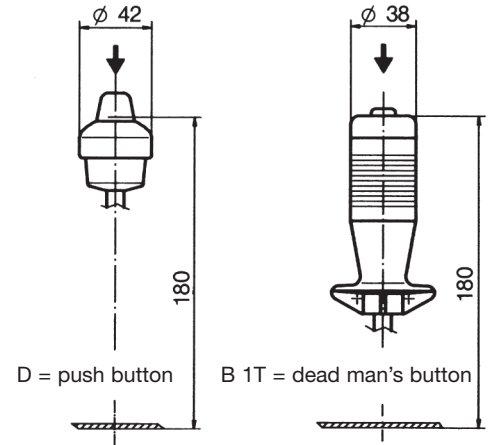
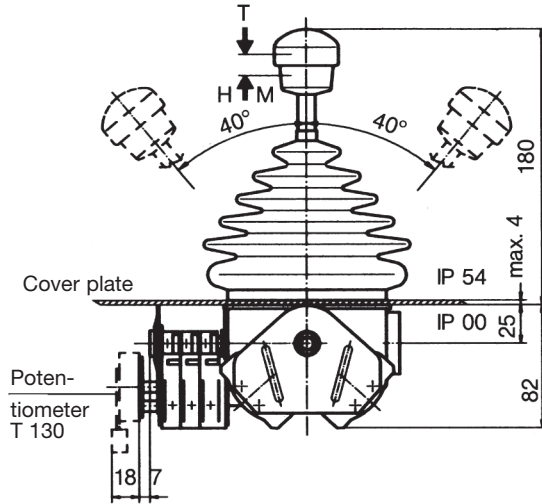

| Type | No. of contacts | Dimension B |
|------|-----------------|-------------|
| 01   | 2               | 77          |
| 02   | 4               | 89          |
| 03   | 6               | 102         |
| 04   | 8               | 114         |
| 05   | 10              | 127         |
| 06   | 12              | 139         |

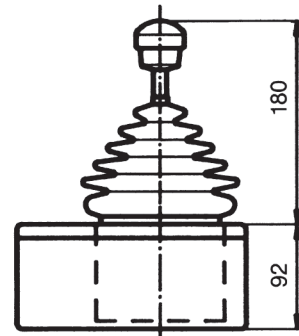
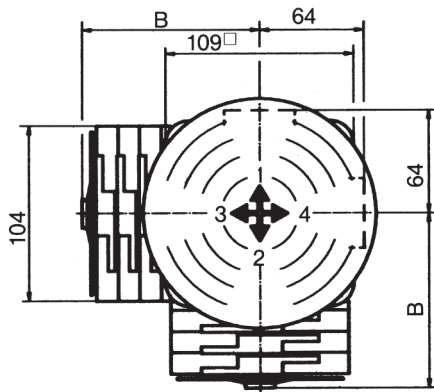

Steel sheet housing

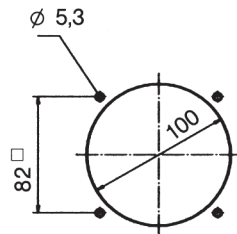

Hole pattern

