



Type KFS2

The crane driver's seat KFS 2 has stepless high adjustment by means of a gas-loaded spring.

The backrest can be tilted, forwards onto the cushion, which in turn can then be tilted 90° sideways.

All these functions are performed easily via levers.

The metal parts are protected against corrosion and painted black.

Technical details:

Horizontal adjustment	100 mm
Backrest adjustment, fine control inclination backwards	max. 10°
Height adjustment	120 mm

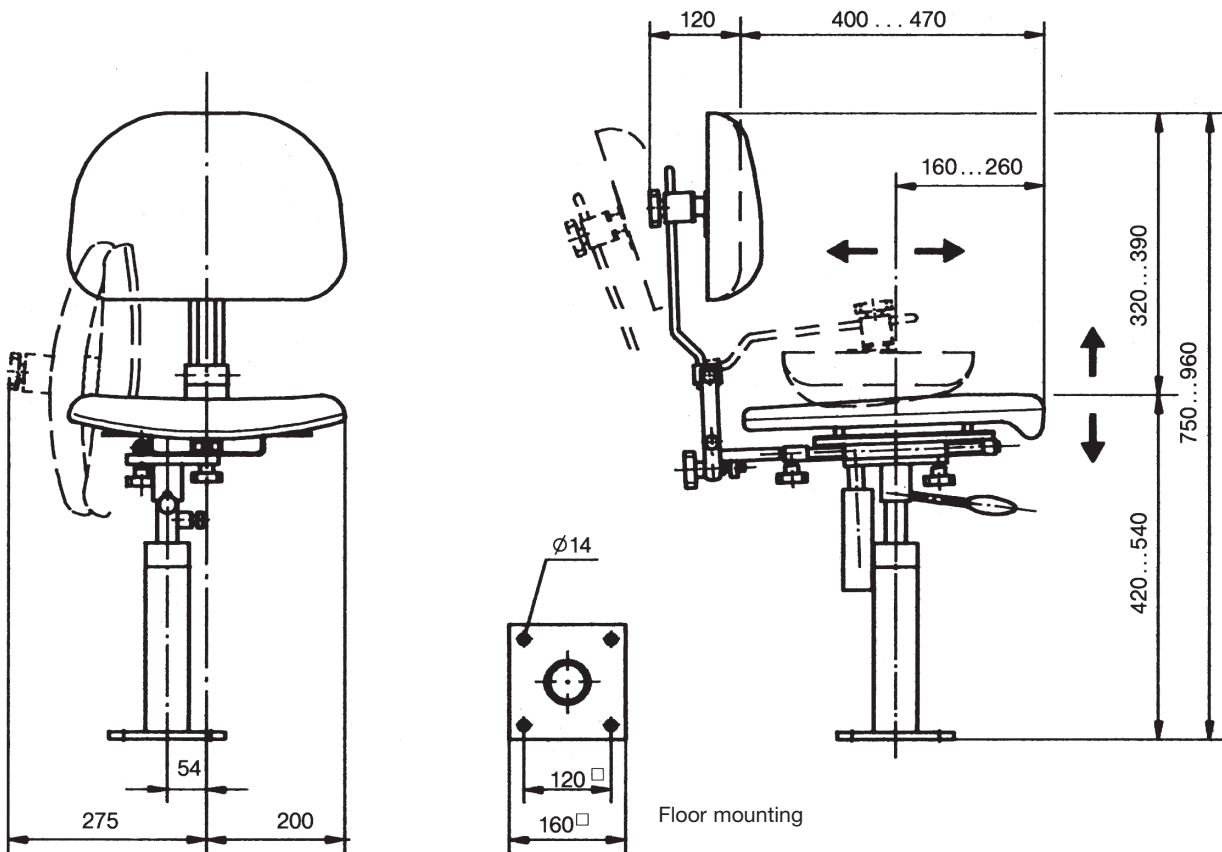

Pos.				Weight kg	Type	Price EURO
1	Driver's seat with air-permeable artificial leather cover black			15	KFS 21	
2	Driver's seat with textil cover grey / black			14	KFS 22	
3						
4						
5						
6						
7						
8						
9						
10						



Type KFS4

The crane driver's seat KFS 4 has stepless high adjustment by means of a gas-loaded spring and an oilhydraulic vibration absorption system with weight adjustment.

The backrest can be tilted, forwards onto the cushion, which in turn can then be tilted 90° sideways.

All these functions are performed easily via levers.

The metal parts are protected against corrosion and painted black.

Technical details:

Suspension stroke	80 mm
Weight adjustment	50-130 kg
Horizontal adjustment	150 mm
Backrest adjustment, fine control inclination backwards	max. 20°
Height adjustment	100 mm

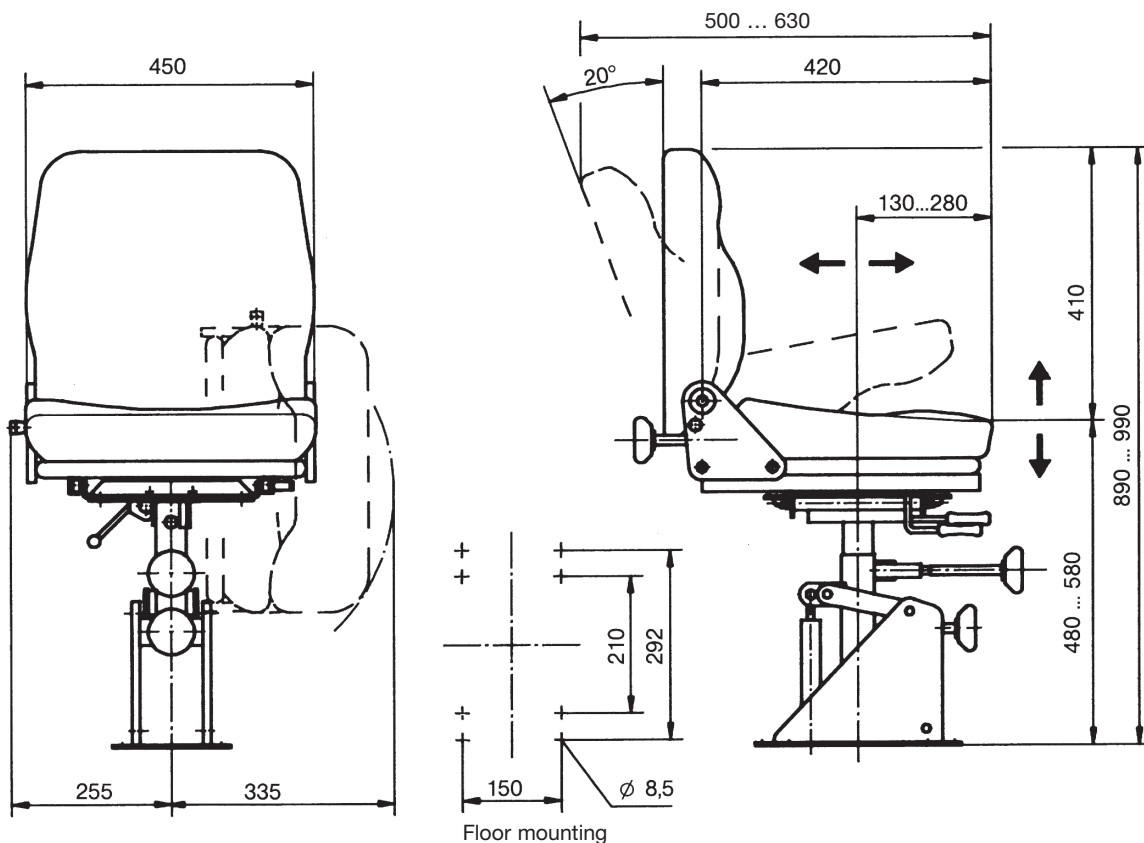

Pos.		Weight kg	Type	Price EURO
1	Driver's seat with air-permeable artificial leather cover black	24	KFS 41	
2	Driver's seat with textil cover grey / black	24	KFS 42	
3				
4	Armrest fully adjustable (2 pieces) 50 mm wide			
5	Armrest fully adjustable (2 pieces) 100 mm wide			
6				
7				
8				
9				
10				



Type KFS62-2-5-6-24

The crane driver's seat KFS 6 is ergonomically designed and provides a high grade of comfort.

The driver's seat is a low level mechanical suspension seat with an oilhydraulic vibration absorption system with weight adjustment.

All adjustment controls are positioned ergonomically within easy access.

For this comfort driver's seat KFS 6 a lot of efficient accessories are available look Pos. 5-25.

The metal parts are protected against corrosion and painted black.

Technical detail:

Suspension stroke	95 mm
Weight adjustment	40-130 kg
Horizontal adjustment	180 mm
Backrest adjustment, fine control inclination backwards	28° (90°)
Height and slope adjustment	65 mm

Pos.				Weight kg	Type	Price EURO
1	Driver's seat standard design with air-permeable artificial leather cover black			25	KFS 61	
2	Driver's seat standard design with textil cover grey / yellow			25	KFS 62	
3						
4						
5	Headrest raint					
6	Armrest fully adjustable (2 pieces) 50 mm wide					
7	Armrest fully adjustable (2 pieces) 100 mm wide					
8	Backrest high + 100 mm inclination backwards max. 56°					
9	Backrest standard with lumbar support manual adjustment					
10						
11	Seat cushion deep adjustment mechanical 60 mm					
12						
13	Seat contact 1 NO 1,5 A 24 V DC					
14	Seat cushion and backrest standard with heating element 24 V DC 42 Watt					
15						
16	Safety belt 2 point fixing					
17	Safety belt 4 point fixing (trouser braces belt) (Pos. 5 additionally required)					
18						
19						
20						
21						
22						
23						
24	Console			10		
25						

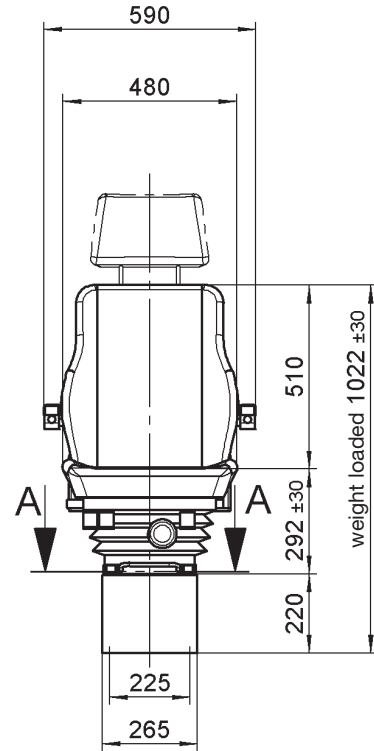
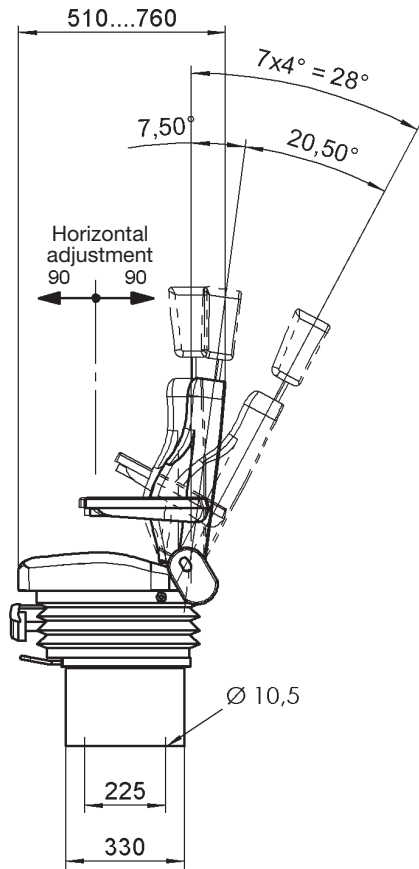

View A-A

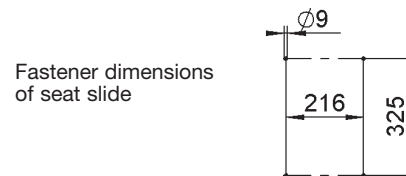

Fastener dimensions
of seat slide

Backrest high

Special equipment

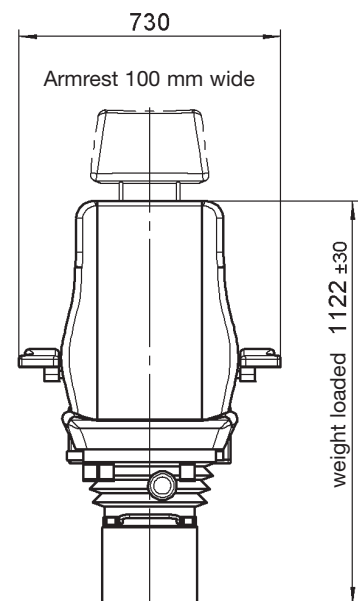
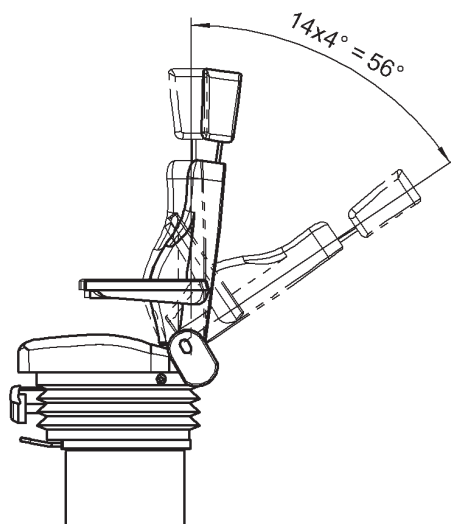



Type KFS72-2-5-7-24

The crane driver's seat KFS 7 is ergonomically designed and provides a high grade of comfort.

The driver's seat is a low level mechanical suspension seat with an oilhydraulic vibration absorption system with weight adjustment.

All adjustment controls are positioned ergonomically within easy access.

For this comfort driver's seat KFS 7 a lot of efficient accessories are available look Pos. 5-25.

The metal parts are protected against corrosion and painted black.

Technical detail:

Suspension stroke	60 mm
Weight adjustment	40-130 kg
Horizontal adjustment	180 mm, dual 300 mm
Backrest adjustment, fine control inclination backwards	28° (90°)
Height and slope adjustment	65 mm

Pos.				Weight kg	Type	Price EURO
1	Driver's seat standard design with air-permeable artificial leather cover black			25	KFS 71	
2	Driver's seat standard design with textil cover grey / yellow			25	KFS 72	
3						
4						
5	Headrest raint					
6	Armrest fully adjustable (2 pieces) 50 mm wide					
7	Armrest fully adjustable (2 pieces) 100 mm wide					
8	Backrest high + 100 mm inclination backwards max. 56°					
9	Backrest standard with lumbar support manual adjustment					
10						
11	Seat cushion deep adjustment mechanical 60 mm					
12	Seat cushion V-cut (free sight to down)					
13	Seat contact 1 NO 1,5 A 24 V DC					
14	Seat cushion and backrest standard with heating element 24 V DC 42 Watt					
15						
16	Safety belt 2 point fixing					
17	Safety belt 4 point fixing (trouser braces belt) (Pos. 5 additionally required)					
18						
19	Horizontal adjustment dual 180 + 120 mm (total 300 mm)					
20						
21						
22						
23						
24	Console			10		
25						

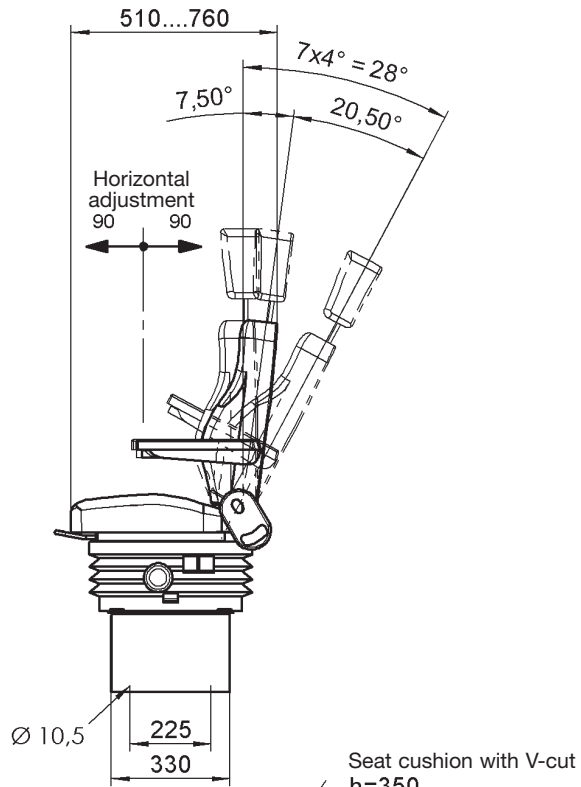

Seat cushion with V-cut
h=350

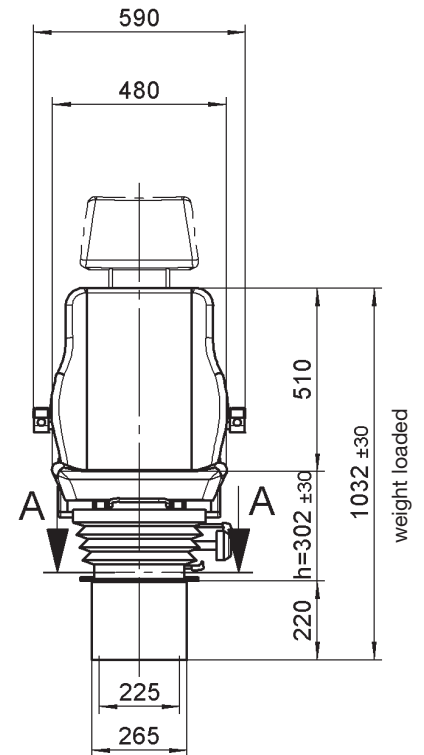
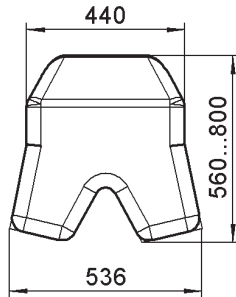

View A-A
 $\varnothing 9$

Fastener dimensions
of seat slide



Special equipment

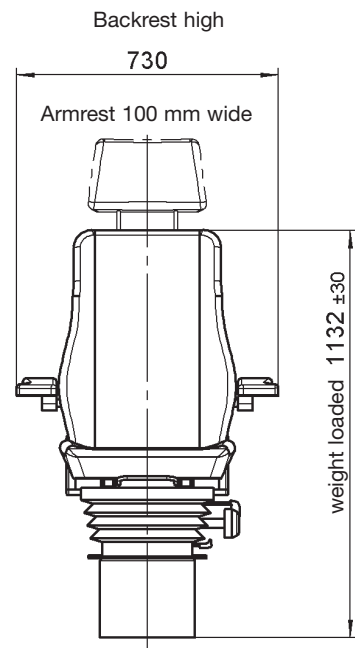
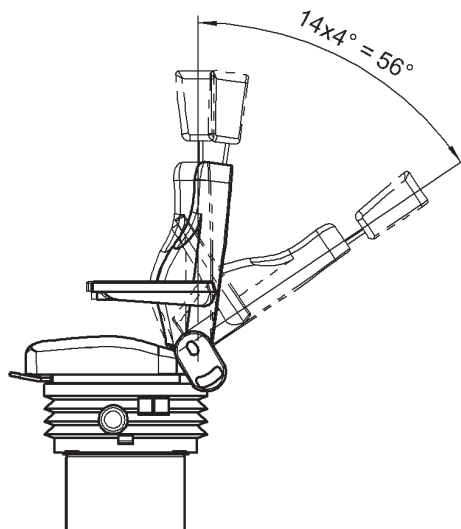



Type KFS82-2-5-6-24-25

The crane driver's seat KFS 8 is a static seat with ergonomically designed and provides a high grade of comfort.

The driver's seat KFS 8 is equipped with roller-bearing swivel system.

All adjustment controls are positioned ergonomically within easy access.

For this comfort driver's seat KFS 8 a lot of efficient accessories are available look Pos. 5-25.

The console are available to build in the heating 2-steps 2 x 2 kW 380 V AC, ventilator 380 V AC, airvolume ca. 1000 m³/h, air circulation (opening in the underside of the console), selector switch for heating / ventilator.

The metal parts are protected against corrosion and painted black.

Technical detail:

Horizontal adjustment 150 mm

Backrest adjustment, fine control inclination backwards 28°

Height and slope adjustment 65 mm

Pos.				Weight kg	Type	Price EURO
1	Driver's seat standard design with air-permeable artificial leather cover black			25	KFS 81	
2	Driver's seat standard design with textil cover grey / black			25	KFS 82	
3						
4						
5	Headrest raint					
6	Armrest fully adjustable (2 pieces) 50 mm wide					
7	Armrest fully adjustable (2 pieces) 100 mm wide					
8	Backrest high + 100 mm inclination backwards max. 90°					
9	Backrest with lumbar support manual adjustment					
10						
11	Seat cushion deep adjustment mechanical 60 mm					
12						
13						
14	Seat cushion and backrest standard with heating element 24 V DC 42 Watt					
15						
16	Safety belt 2 point fixing					
17	Safety belt 4 point fixing (trouser braces belt) (Pos. 5 additionally required)					
18						
19						
20						
21						
22						
23	Roller-bearing swivel system for seat (included in Pos. 1, 2)					
24	Console			10		
25	Heating 2 steps 2 x 2 kW 380 V AC with ventilator 380 V AC airvolume ca. 1000 m³/h with selector switch for heating / ventilator mounting into the console			10		



Type KFS92-2-5-6-24

The crane driver's seat KFS 9 is ergonomically designed and provides a high grade of comfort.

The driver's seat is a low level mechanical suspension seat with an oilhydraulic vibration absorption system with weight adjustment.

All adjustment controls are positioned ergonomically within easy access.

For this comfort driver's seat KFS 9 a lot of efficient accessories are available look Pos. 5-25.

The metal parts are protected against corrosion and painted black.

Technical detail:

Suspension stroke	80 mm
Weight adjustment	50-120 kg
Horizontal adjustment	160 mm
Backrest adjustment stepless inclination backwards	90°
Height and slope adjustment	60 mm

Pos.				Weight kg	Type	Price EURO
1	Driver's seat standard design with air-permeable artificial leather cover black			25	KFS 91	
2	Driver's seat standard design with textil cover grey / black			25	KFS 92	
3						
4						
5	Headrest raint					
6	Armrest adjustable (2 pieces) 50 mm wide					
7	Armrest adjustable (2 pieces) 100 mm wide					
8						
9	Backrest with lumbar support manual adjustment 2 movement					
10	Backrest with lumbar support manual adjustment 4 movement					
11						
12	Seat cushion V-cut (free sight to down) (Pos. 19 required)					
13	Seat contact 1 NO 1,5 A 24 V DC					
14	Seat cushion and backrest standard with heating element 24 V DC 47 Watt					
15	Seat cushion deep prolongation + 35 mm					
16	Safety belt 2 point fixing					
17	Safety belt 4 point fixing (trouser braces belt) (Pos. 5 additionally required)					
18						
19	Horizontal adjustment dual 160 + 120 mm (total 280 mm seat height + 30 mm)					
20	Pneumatic vibration absorption system with weight adjustment by compressor 24 V DC 8 Ampere					
21	Plate for horizontal manual adjustment of seat adjustable 500 mm with floor mounting plate					
22						
23	Loose cover			10		
24	Console					
25						

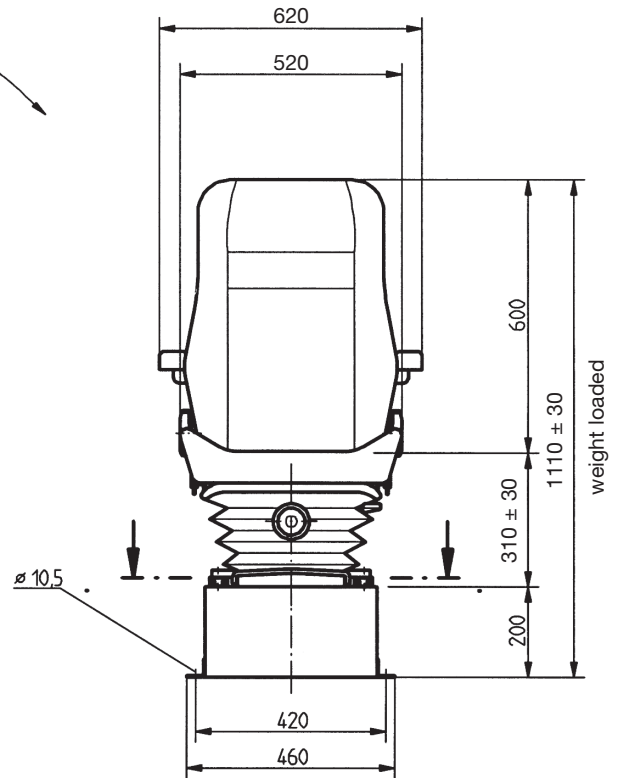
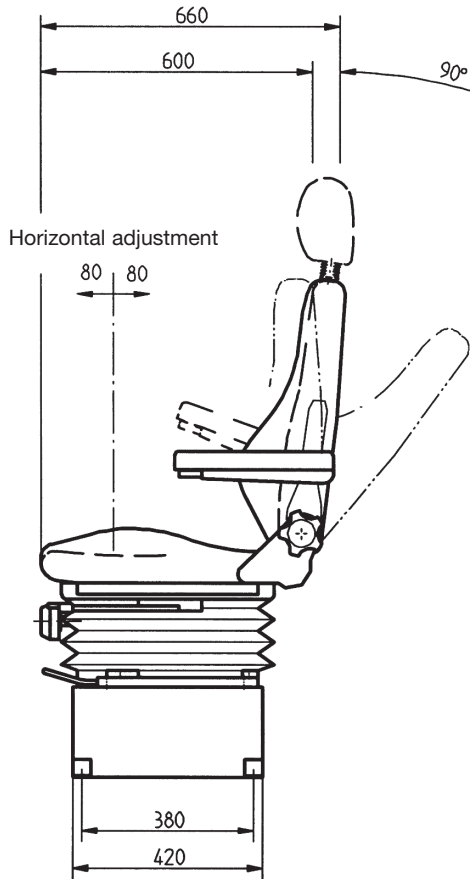

manual adjustment of seat
adjustable 500 mm

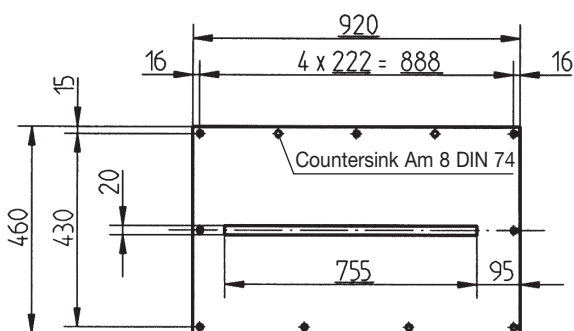
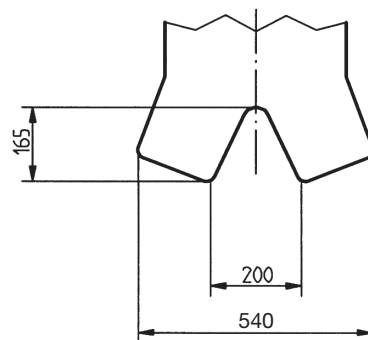
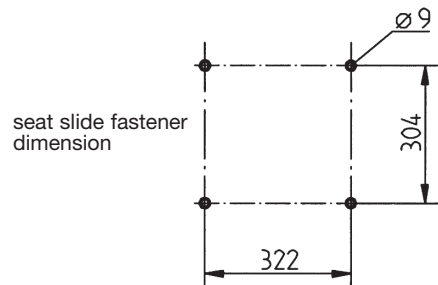
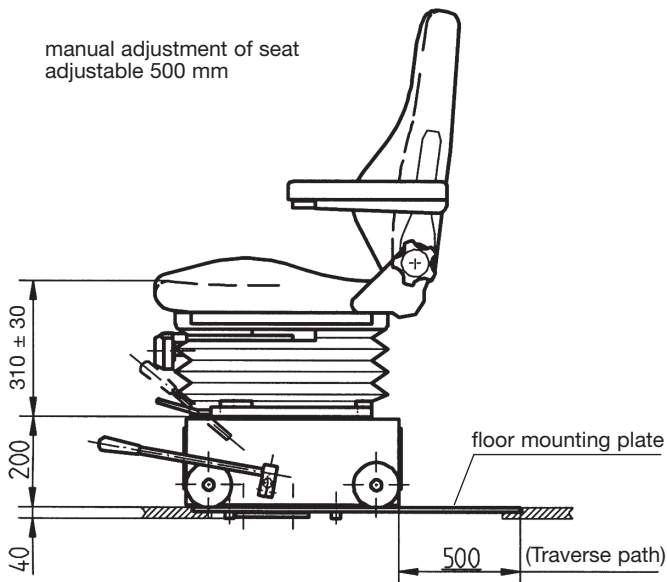



Type KFS102-2-5-7-12-24

The crane driver's seat KFS 10 is ergonomically designed and provides a high grade of comfort.

The driver's seat is a low level mechanical suspension seat with a pneumatic vibration absorption system with weight adjustment by compressor 24 V DC 8 Ampere.

All adjustment controls are positioned ergonomically within easy access.

For this comfort driver's seat KFS 10 a lot of efficient accessories are available look Pos. 5-25.

The metal parts are protected against corrosion and painted black.

Technical detail:

Suspension stroke pneumatic	80 mm
Weight adjustment	50-130 kg
Horizontal adjustment seat with suspension system	160 mm
Horizontal adjustment seat with backrest	260 mm
Horizontal adjustment only seat cushion	150 mm
Backrest adjustment stepless inclination backwards	90°
Height and slope adjustment mechanical	60 mm

Pos.				Weight kg	Type	Price EURO
1	Driver's seat standard design with air-permeable artificial leather cover black			25	KFS 101	
2	Driver's seat standard design with textil cover grey / black			25	KFS 102	
3						
4						
5	Headrest raint					
6	Armrest adjustable (2 pieces) 50 mm wide					
7	Armrest adjustable (2 pieces) 100 mm wide					
8						
9	Backrest with lumbar support manual adjustment 2 movement					
10	Backrest with lumbar support manual adjustment 4 movement					
11						
12	Seat cushion V-cut (free sight to down)					
13	Seat contact 1 NO 1,5 A 24 V DC					
14	Seat cushion and backrest standard with heating element 24 V DC 47 Watt					
15	Seat cushion deep prolongation +35 mm					
16	Safety belt 2 point fixing					
17	Safety belt 4 point fixing (trouser braces belt) (Pos. 5 additionally required)					
18						
19						
20						
21						
22						
23						
24	Console			10		
25						

